

GEC...XS,XS-2RS (d 320~460)

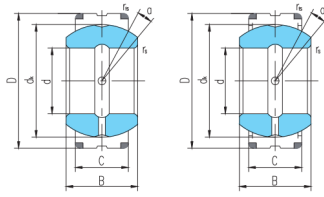

GEC...XS

GEC...XS-2RS

select	Inquiry	轴承型号		外形尺寸mm								额定载重	重量
		-	-	d	D	B	C	d <sub>k</sub>	r <sub>s</sub> min	r <sub>1s</sub> min	a°	动载 荷	静载 kg
GEC320XS	GEC320XS-2RS	320	440	160	135	380	1.1	3	4	4400	22000	78	
GEC340XS	GEC340XS-2RS	340	460	160	135	400	1.1	3	3	4650	23200	83	
GEC360XS	GEC360XS-2RS	360	480	160	135	420	1.1	3	3	4800	24000	87	
GEC380XS	GEC380XS-2RS	380	520	190	160	450	1.5	4	4	6300	31500	129	
GEC400XS	GEC400XS-2RS	400	540	190	160	470	1.5	4	3	6550	32500	135	
GEC420XS	GEC420XS-2RS	420	560	190	160	490	1.5	4	3	6800	34500	141	
GEC440XS	GEC440XS-2RS	440	600	218	185	520	1.5	4	3	8650	42300	196	
GEC460XS	GEC460XS-2RS	460	620	218	185	540	1.5	4	3	9000	45000	204	