

# SA...ET-2RS(d 15~80)

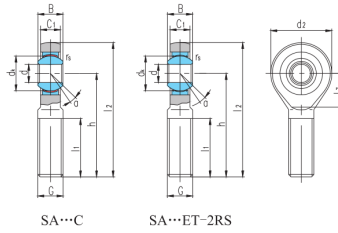

select	Inquiry	轴承型号		外形尺寸mm												额定载重
		Bearing number	d	B	dk	C <sub>1</sub> max	d <sub>2</sub>	G 6g	h	l <sub>1</sub> min	l <sub>2</sub>	l <sub>7</sub>	rs min	a°	动载荷 kN	静载 kg
SA15ET-2RS	15	12	22	10.5	40	M14	63	34	83	21	0.3	8	25	32	0.12	
SA17ET-2RS	17	14	25	11.5	46	M16	69	36	92	24	0.3	10	32	44	0.19	
SA20ET-2RS	20	16	29	13.5	53	M20×1.5	78	43	104.5	25.5	0.3	995	45	60	0.31	
SA25ET-2RS	25	20	35.5	18	64	M24×2	94	53	126	31	0.6	7	85	83	0.56	
SA30ET-2RS	30	22	40.7	20	73	M30×2	110	65	146.5	35.5	0.6	6	110	110	0.89	
SA35ET-2RS	35	25	47	22	82	M36x3	140	82	181	41	0.6	6	140	146	1.4	
SA40ET-2RS	40	28	53	24	92	M39x3	150	86	196	47	0.6	7	175	180	1.8	
SA45ET-2RS	45	32	60	28	102	M42x3	163	92	214	52	0.6	7	225	240	2.5	
SA50ET-2RS	50	35	66	31	112	M45x3	185	104	241	60	0.6	6	275	290	3.6	
SA60ET-2RS	60	44	80	39	135	M52x3	210	115	277.5	75.5	1	6	430	450	5.7	
SA70ET-2RS	70	49	92	43	160	M56x4	235	125	315	95	1	6	550	610	7.9	
SA80ET-2RS	80	55	105	48	180	M64x4	270	140	360	105.5	1	6	705	750	12	