

SIQ...ES

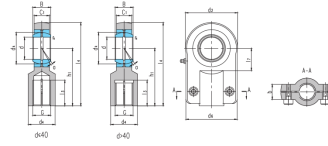

select	Inquiry	轴承 型号	尺寸 mm															额定载荷kN		重量 Kg
			d	B	dk	C1	d2	6H	h1	l3	l4	l7	d4	d6	b	rs	a°	动载荷	静载 荷	
SIQ100ES	100	70	130	57	240	M64x3	240	102	360	116	110	190	55	1	7	607	865	M24x55	28.4	
SIQ80ES	80	55	105	47	205	M48x2	185	75	287.5	92	90	156	45	1	6	400	585	M20x45	16.2	
SIQ60ES	60	44	80	38	160	M42x2	150	65	230	68	68	134	36	1	6	245	380	M16x35	8.2	
SIQ50ES	50	35	66	30	120	M33x2	130	54	190	58	55	105	30	0.6	6	156	245	M12x30	3.9	
SIQ40ES	40	28	53	23	100	M27x2	105	37	155	45	45	90	23	0.6	7	99	156	M10x25	2.16	
SIQ30ES	30	22	40.7	19	80	M20x1.5	85	29	125	35	36	77	19	0.6	6	62	108	M10x20	1.25	
SIQ25ES	25	20	35.5	17	65	M16x1.5	68	23	100.5	30	30	62	17	0.6	7	48	67	M8x16	0.67	
SIQ20ES2)	20	16	29	13	55	M14x1.5	58	19	85.5	25	25	55	17	0.3	9	30	42.5	M8x16	0.43	
SIQ16ES1 2)	16	14	25	11	45	M12x1.25	48	17	70.5	20	21	45	13	0.3	10	21	28.5	M6x12	0.22	
SIQ12E 1)	12	10	18	8	35	M10x1.25	42	15	59.5	16	17	35	13	0.3	10	10	17	M6x12	0.12	