

GEFZ..S (d 4.83~25.4)

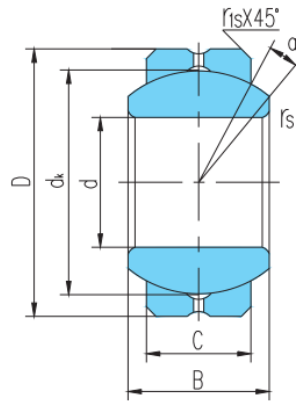

select	Inquiry	轴承型号		外形尺寸mm								额定载	重
		Bearing number	d	D	B	C	d_k	r_s min	r_{1s} min	a°	荷kN	量	
												动载荷	静载 kg
GEFZ4S	4.83	14.29	7.14	5.54	10.31	0.3	0.38	11	3	15	0.006		
GEFZ4S	0.19	0.5625	0.281	0.218	0.406	0.012	0.015	11	3	15	0.006		
GEFZ6S	6.35	16.67	8.71	6.35	12.7	0.3	0.56	13.5	4.4	22	0.010		
GEFZ6S	0.25	0.6562	0.343	0.25	0.5	0.012	0.022	13.5	4.4	22	0.010		
GEFZ7S	7.94	19.05	9.53	7.14	14.27	0.3	0.81	12	6	28	0.014		
GEFZ7S	0.3125	0.75	0.375	0.281	0.562	0.012	0.032	12	6	28	0.014		
GEFZ9S	9.53	20.64	10.31	7.92	16.66	3	0.81	10	7.4	37	0.018		
GEFZ9S	0.375	0.8125	0.406	0.312	0.656	0.012	0.032	10	7.4	37	0.018		
GEFZ11S	11.11	23.02	11.1	8.71	17.45	0.3	0.81	8	8.4	42	0.021		
GEFZ11S	0.4375	0.9062	0.437	0.343	0.687	0.012	0.032	8	8.4	42	0.021		
GEFZ12S	12.70	25.40	12.70	9.91	20.65	0.3	0.81	9.5	12	58	0.029		
GEFZ12S	0.5	1	0.5	0.39	0.813	0.012	0.032	9.5	12	58	0.029		
GEFZ14S	14.29	27.78	14.27	11.1	23.01	0.3	0.81	9.5	15	73	0.042		
GEFZ14S	0.5625	1.0937	0.562	0.437	0.906	0.012	0.032	9.5	15	73	0.042		
GEFZ15S	15.88	30.16	15.88	12.7	25.4	0.3	0.81	9.5	19	94	0.053		
GEFZ15S	0.625	1.1875	0.625	0.5	1	0.012	0.032	9.5	19	94	0.053		
GEFZ19S	19.05	36.51	19.05	15.06	30.15	0.3	1.12	9	28	141	0.094		
GEFZ19S	0.75	1.4375	0.75	0.593	1.187	0.012	0.044	9	28	141	0.094		

GEFZ..S (d 4.83~25.4)

GEFZ22S	22.23	39.69	22.23	17.86	33.32	0.6	1.12	9.5	37	186	0.119
GEFZ22S	0.875	1.5625	0.875	0.703	1.312	0.024	0.044	9.5	37	186	0.119
GEFZ25S	25.4	44.45	25.4	20.24	38.1	0.6	1.12	10	49	245	0.173
GEFZ25S	1	1.75	1	0.797	1.5	0.024	0.044	10	49	245	0.173