

SA...C(d 5□30)

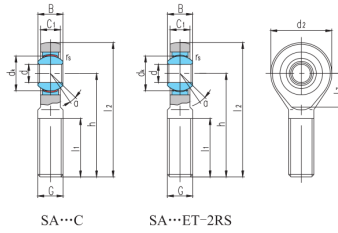

select	Inquiry	轴承型号		外形尺寸mm												额定载	重
		Bearing number	d	B	dk	C ₁ max	d ₂	G 6g	h	l ₁ min	l ₂	l ₇	rs min	a°	动载荷	静载荷	
		SA5C	5	6	10	4.5	21	M5	36	16	46.5	11.5	0.3	13	3.6	3.9	0.017
		SA6C	6	6	10	4.5	21	M6	36	16	46.5	11.5	0.3	13	3.6	5.5	0.017
		SA8C	8	8	13	6.5	24	M8	42	21	54	13	0.3	15	5.8	10	0.029
		SA10C	10	9	16	7.5	29	M10	48	26	62.5	15.5	0.3	12	8.6	16	0.05
		SA12C	12	10	18	8.5	34	M12	54	28	71	18	0.3	10	11	23	0.066
		SA15C	15	12	22	10.5	40	M14	63	34	83	21	0.3	8	18	32	0.12
		SA17C	17	14	25	11.5	46	M16	69	36	92	24	0.3	10	22	44	0.19
		SA20C	20	16	29	13.5	53	M20x1.5	78	43	104.5	25.5	0.3	9	31	60	0.31
		SA25C	25	20	35.5	18	64	M24x2	94	53	126	31	0.6	7	51	83	0.56
		SA30C	30	22	40.7	20	73	M30x2	110	65	146.5	35.5	0.6	6	65	110	0.89