

# SIQ...ES(d 12~100)

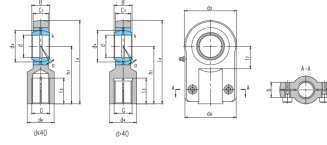

select	Inquiry	轴承型号		外形尺寸mm														额定载荷kN		锁紧螺重
		Bearing number	d	B	d <sub>k</sub>	C <sub>1</sub>	d <sub>2</sub>	G 6H	h <sub>1</sub>	l <sub>3</sub>	l <sub>4</sub>	l <sub>7</sub>	d <sub>4</sub>	d <sub>6</sub>	b	r <sub>s</sub>	a°	动载荷	静载荷	Screw kg
SIQ12E 1)	12	10	18	8	35	M10xl.25	42	15	59.5	16	17	35	13	0.3	10	10	17	M6xl2	0.12	
SIQ16ES1 2)	16	14	25	11	45	M12xl.25	48	17	70.5	20	21	45	13	0.3	10	21	28.5	M6xl2	0.22	
SIQ20ES2)	20	16	29	13	55	M14xl.5	58	19	85.5	25	25	55	17	0.3	9	30	42.5	M8xl6	0.43	
SIQ25ES	25	20	35.5	17	65	M16xl.5	68	23	100.5	30	30	62	17	0.6	7	48	67	M8xl6	0.67	
SIQ30ES	30	22	40.7	19	80	M20xl.5	85	29	125	35	36	77	19	0.6	6	62	108	M10x20	1.25	
SIQ40ES	40	28	53	23	100	M27x2	105	37	155	45	45	90	23	0.6	7	99	156	M10x25	2.16	
SIQ50ES	50	35	66	30	120	M33x2	130	54	190	58	55	105	30	0.6	6	156	245	M12x30	3.9	
SIQ60ES	60	44	80	38	160	M42x2	150	65	230	68	68	134	36	1	6	245	380	M16x35	8.2	
SIQ80ES	80	55	105	47	205	M48x2	185	75	287.5	92	90	156	45	1	6	400	585	M20x45	16.2	
SIQ100ES	100	70	130	57	240	M64x3	240	102	360	116	110	190	55	1	7	607	865	M24x55	28.4	